

HMG 500 Series



General

The HMG 500 Portable Data Recorder is a hand-held measuring unit for simple measuring tasks on hydraulic and pneumatic systems. Typical applications are in analysis, maintenance and service.

The HMG 500 has two analog input channels and can record the signals from HYDAC HSI sensors which are connected to it. HSI sensors (*HYDAC Sensor Interface*) are HYDAC sensors for pressure, temperature, and flow rate with automatic sensor recognition.

The HMG 500 automatically reads the measuring range and unit from each sensor that is connected. Manual adjustments of the measuring range settings are no longer required.

The measured values, actual, minimum and maximum, are recorded from the sensors. Depending on the requirement and setting, the following are displayed: the actual measured values (*channel A, B*), the minimum or the maximum values (*channel A, B*). The min/max values can be reset at any time at the touch of a button.

Furthermore the HMG 500 is capable of measuring and displaying the differential between the values on channel A and B (*channel A - B*).

General Specifications

Items supplied:

- HMG 500
- Manual D/E/F
- 9 V battery

Dimensions: 3.94 x 6.69 x 1.57 in. (100 x 170 x 40 mm)

Weight: 0.90 lbs. (0.41 kg)

Operating/Ambient Conditions

Operating temperature: 41° - 122°F (5° to 60°C)

Storage temperature: -4° - 158°F (-20° to 70°C)

Relative humidity: 0 to 70 %

Power Supply

A standard 9 V battery is required for operation. It is also possible to operate the unit using the AC mains adaptor plug listed under Accessories.

Special Features

Adjustment function for mechanical pressure switches

Technical Details

Sensor inputs:

The HMG 500 has two analog inputs on 2 input connections (*channel A and B*) for connecting HSI sensors with automatic sensor recognition (*pressure, temperature and flow rate transmitters*).

Channel A and B:

- Automatic sensor recognition for HSI sensors (*pressure, temperature or flow rate transmitters*) and setting of measuring range and unit of measurement
- Measured value differential for channel A - B

Measurement accuracy of the input channels:

- $\leq \pm 0.1\%$ of the measuring range

Measurement rate:

- 0.1 ms

Measurement & Display:

- Actual measured value
- Min/max values
- Measured value differential
- Change of the unit of measurement

Operating time using 9V battery (2 sensors):

- approx. 10 hours.

HMG 500 Kit #1: Part #00909470

Includes:

- HMG 500-000
- HDA 4748-H-0600-000
- ZBE 30-02 (cable M12x1 for HMG) 2m
- Gauge Adapter G1/4 female to Testpoint 16x2
- Case for HMG 500

HMG 500 Kit #2: Part #00909471

Includes:

- HMG 500-000
- 2 pcs. HDA 4748-H-0600-000
- 2 pcs. ZBE 30-02 (cable M12x1 for HMG) 2m
- 2 pcs. Gauge Adapter G1/4 female to Testpoint 16x2
- Case for HMG 500

HMG Display Panel & Connections

1. **On/Off button**
2. **Mode**
Adjusting the menus
3. **Reset**
Resetting the min/max values
4. **Min/Max**
Display of the minimum and maximum values
5. **Display**
6. **Sensor Input Connector (Channel A)**
7. **Sensor Input Connector (Channel B)**
8. **Protective Cover**
Connection for AC adaptor
9. **Battery Compartment**

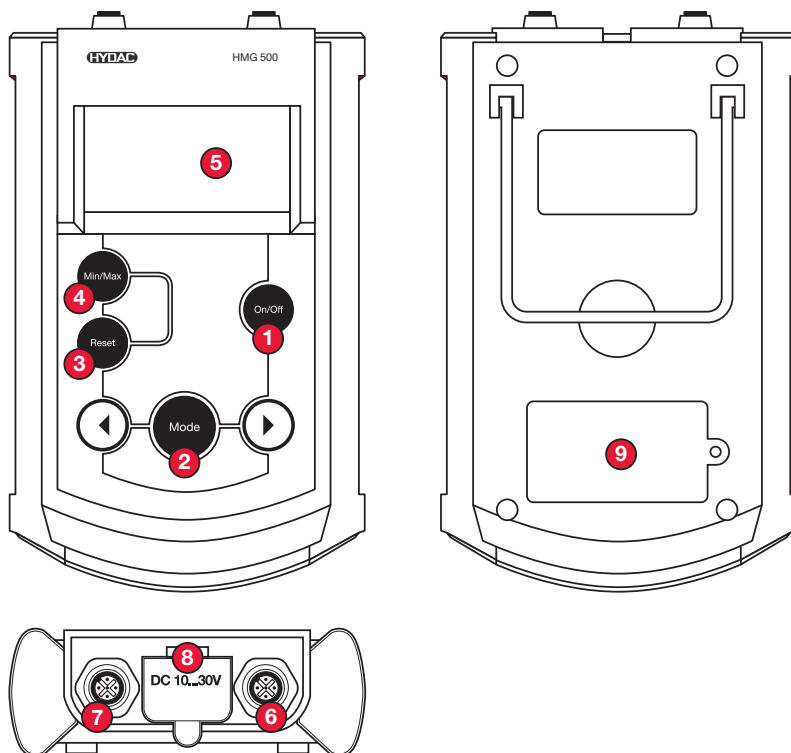

Diagnostic Unit

Model Code	Description	Part No.
HMG 500-000-E	Includes: • HMG 500-000-E with Manual • 9V Battery	00909101

Pressure Transducer with HSI

(HYDAC Sensor Interface)

Model Code	Description	Part No.
HDA 4748-H-0009-000	-15 to 131 psi (-1 to 9 bar)	00909429
HDA 4748-H-0016-000	0 to 232 psi (0 to 16 bar)	00909425
HDA 4748-H-0060-000	0 to 870 psi (0 to 60 bar)	00909554
HDA 4748-H-0100-000	0 to 1450 psi (0 to 100 bar)	00909426
HDA 4748-H-0250-000	0 to 3626 psi (0 to 250 bar)	00909337
HDA 4748-H-0400-000	0 to 5802 psi (0 to 400 bar)	00909427
HDA 4748-H-0600-000	0 to 8702 psi (0 to 600 bar)	00909428

Temperature Transducer with HSI

(HYDAC Sensor Interface)

Model Code	Description	Part No.
ETS 4548-H-000	-13° to 212°F (-25° to 100°C)	00909298

Flow Sensor with HSI (HYDAC Sensor Interface)

Model Code	Description - g/min (l/min)	Part No.
Aluminum		
EVS 3108-H-0020-000	0.3 to 5.3 (1.2 to 20)	00909405
EVS 3108-H-0060-000	1.6 to 15.9 (6 to 60)	00909293
EVS 3108-H-0300-000	4.0 to 79.3 (15 to 300)	00909404
EVS 3108-H-0600-000	10.6 to 159 (40 to 600)	00909403
Stainless Steel		
EVS 3118-H-0020-000	0.3 to 5.3 (1.2 to 20)	00909409
EVS 3118-H-0060-000	1.6 to 15.9 (6 to 60)	00909406
EVS 3118-H-0300-000	4.0 to 79.3 (15 to 300)	00909408
EVS 3118-H-0600-000	10.6 to 159 (40 to 600)	00909407

Accessories

Model Code	Description	Part No.
ZBE 30-02	cable for M12x1 - 2 meters	06040851
ZBE 30-05	cable for M12x1 - 5 meters	06040852
ZBE 34	M12x1 / Binder adaptor	03236597
ZBE 35	M12x1 / Hirschmann adaptor	03236601
ZBE 36	AS 1000 (Aqua Sensor) Adapter	00909737
ZBE 38	M12 Y-adaptor (doubles the inputs)	03224436
Plastic Case	for HMG 500 & accessories	06043006
Power Supply	24 VDC power supply	02702416